

INDUSTRIAL LENS



Industrial lens design / manufacturing

L I G H T I N G · S O L U T I O N

L I G H T I N G S O L U T I O N

LENS FIELD OF VIEW

FOV Comparison Table-4.3mm																					
WD	Magnification	4.5mm Industrial Lens FOV on Various Sensor Size																			
		4/3"		1.1"		1"		2/3"		1/1.7"		1/1.8"		1/2"		1/2.3"		1/2.5"		1/3"	
		H	V	H	V	H	V	H	V	H	V	H	V	H	V	H	V	H	V	H	V
1500	0.003	6000.0	4600.0	4733.3	3466.7	4433.3	2956.7	2873.3	2363.3	2510.0	1880.0	2400.0	1800.0	2133.3	1600.0	2136.7	1530.0	1933.3	1433.3	1600.0	1200.0
1200	0.004	4800.0	3680.0	3786.7	2773.3	3546.7	2365.3	2298.7	1890.7	2008.0	1504.0	1920.0	1440.0	1706.7	1280.0	1709.3	1224.0	1546.7	1146.7	1280.0	960.0
1000	0.005	4000.0	3066.7	3155.6	2311.1	2955.6	1971.1	1915.6	1575.6	1673.3	1253.3	1600.0	1200.0	1422.2	1066.7	1424.4	1020.0	1288.9	955.6	1066.7	800.0
900	0.005	3600.0	2760.0	2840.0	2080.0	2660.0	1774.0	1724.0	1418.0	1506.0	1128.0	1440.0	1080.0	1280.0	960.0	1160.0	860.0	1160.0	860.0	960.0	720.0
800	0.006	3200.0	2453.3	2524.4	1848.9	2364.4	1576.9	1532.4	1260.4	1338.7	1002.7	1280.0	960.0	1137.8	853.3	1139.6	816.0	1031.1	764.4	853.3	640.0
700	0.006	2800.0	2146.7	2208.9	1617.8	2068.9	1379.8	1340.9	1102.9	1171.3	877.3	1120.0	840.0	995.6	746.7	997.1	714.0	902.2	668.9	746.7	560.0
600	0.008	2400.0	1840.0	1893.3	1386.7	1773.3	1182.7	1149.3	945.3	1004.0	752.0	960.0	720.0	853.3	640.0	854.7	612.0	773.3	573.3	640.0	480.0
500	0.009	2000.0	1533.3	1577.8	1155.6	1477.8	985.6	957.8	787.8	836.7	626.7	800.0	600.0	711.1	533.3	712.2	510.0	644.4	477.8	533.3	400.0
400	0.011	1600.0	1226.7	1262.2	924.4	1182.2	788.4	766.2	630.2	669.3	501.3	640.0	480.0	568.9	426.7	569.8	408.0	515.6	382.2	426.7	320.0
300	0.015	1200.0	920.0	946.7	693.3	886.7	591.3	574.7	472.7	502.0	376.0	480.0	360.0	426.7	320.0	427.3	306.0	386.7	286.7	320.0	240.0
200	0.023	800.0	613.3	631.1	462.2	591.1	394.2	383.1	315.1	334.7	250.7	320.0	240.0	284.4	213.3	284.0	204.0	257.8	191.1	213.3	160.0
100	0.045	400.0	306.7	315.6	231.1	295.6	197.1	191.6	157.6	167.3	125.3	160.0	120.0	142.2	106.7	142.4	102.0	128.9	95.6	106.7	80.0
50	0.090	200.0	153.3	157.8	115.6	147.8	98.6	95.8	78.8	83.7	62.7	80.0	60.0	71.1	53.3	71.2	51.0	64.4	47.8	53.3	40.0

LENS FIELD OF VIEW

FOV Comparison Table-12mm																					
WD	Magnification	12mm Industrial Lens FOV on Various Sensor Size																			
		4/3"		1.1"		1"		2/3"		1/1.7"		1/1.8"		1/2"		1/2.3"		1/2.5"		1/3"	
		H	V	H	V	H	V	H	V	H	V	H	V	H	V	H	V	H	V	H	V
1500	0.008	2250.0	1725.0	1775.0	1300.0	1662.5	1108.8	1077.5	886.3	941.3	705.0	900.0	675.0	800.0	600.0	801.3	573.8	725.0	537.5	600.0	450.0
1200	0.010	1800.0	1380.0	1420.0	1040.0	1330.0	887.0	862.0	709.0	753.0	564.0	720.0	540.0	640.0	480.0	641.0	459.0	580.0	430.0	480.0	360.0
1000	0.012	1500.0	1150.0	1183.3	866.7	1108.3	739.2	718.3	590.8	627.5	470.0	600.0	450.0	533.3	400.0	534.2	382.5	483.3	358.3	400.0	300.0
900	0.013	1350.0	1035.0	1065.0	780.0	997.5	665.3	646.5	531.8	564.8	423.0	540.0	405.0	480.0	360.0	480.8	344.3	435.0	322.5	360.0	270.0
800	0.015	1200.0	920.0	946.7	693.3	886.7	591.3	574.7	472.7	502.0	376.0	480.0	360.0	426.7	320.0	427.3	306.0	386.7	286.7	320.0	240.0
700	0.017	1050.0	805.0	828.3	606.7	775.8	517.4	502.8	413.6	439.3	329.0	420.0	315.0	373.3	280.0	373.9	267.8	338.3	250.8	280.0	210.0
600	0.020	900.0	690.0	710.0	520.0	665.0	443.5	431.0	354.5	376.5	282.0	360.0	270.0	320.0	240.0	320.5	229.5	290.0	215.0	240.0	180.0
500	0.024	750.0	575.0	591.7	433.3	554.2	369.6	359.2	295.4	313.8	235.0	300.0	225.0	266.7	200.0	267.1	191.3	241.7	179.2	200.0	150.0
400	0.030	600.0	460.0	473.3	346.7	443.3	295.7	287.3	236.3	251.0	188.0	240.0	180.0	213.3	160.0	213.7	153.0	193.3	143.3	160.0	120.0
300	0.040	450.0	345.0	355.0	260.0	332.5	221.8	215.5	177.3	188.3	141.0	180.0	135.0	160.0	120.0	160.3	114.8	145.0	107.5	120.0	90.0
200	0.060	300.0	230.0	236.7	173.3	221.7	147.8	143.7	118.2	125.5	94.0	120.0	90.0	106.7	80.0	106.8	76.5	96.7	71.7	80.0	60.0
100	0.120	150.0	115.0	118.8	86.7	110.8	73.9	71.8	59.1	62.8	47.0	60.0	45.0	53.3	40.0	53.4	38.3	48.3	35.8	40.0	30.0
50	0.240	75.0	57.5	59.2	43.3	55.4	37.0	35.9	29.5	31.4	23.5	30.0	22.5	26.7	20.0	26.7	19.1	24.2	17.9	20.0	15.0

FOV Comparison Table-6mm																					
WD	Magnification	6mm Industrial Lens FOV on Various Sensor Size																			
		4/3"		1.1"		1"		2/3"		1/1.7"		1/1.8"		1/2"		1/2.3"		1/2.5"		1/3"	
		H	V	H	V	H	V	H	V	H	V	H	V	H	V	H	V	H	V	H	V
1500	0.004	4500.0	3450.0	3550.0	2600.0	3225.0	2217.5	2155.0	1772.5	1882.5	1410.0	1800.0	1350.0	1600.0	1200.0	1602.5	1147.5	1450.0	1075.0	1200.0	900.0
1200	0.005	3600.0	2760.0	2840.0	2080.0	2660.0	1774.0	1724.0	1418.0	1506.0	1128.0	1440.0	1080.0	1280.0	960.0	1282.0	918.0	1160.0	860.0	960.0	720.0
1000	0.006	3000.0	2300.0	2366.7	1733.3	2216.7	1478.3	1436.7	1181.7	1255.0	940.0	1200.0	900.0	1066.7	800.0	1068.3	765.0	966.7	716.7	800.0	600.0
900	0.007	2700.0	2070.0	2130.0	1560.0	1995.0	1330.0	1293.0	1063.5	1129.5	846.0	1080.0	810.0	960.0	720.0	961.5	685.0	876.0	645.0	720.0	540.0
800	0.008	2400.0	1840.0	1893.3	1386.7	1773.3	1182.7	1149.3	945.3	1004.0	752.0	960.0	720.0	853.3	640.0	854.7	612.0	773.3	573.3	640.0	480.0
700	0.009	2100.0	1610.0	1656.7	1213.3	1551.7	1034.8	1005.7	827.2	878.5	658.0	840.0	630.0	746.7	560.0	747.8	535.5	676.7	501.7	560.0	420.0
600	0.010	1800.0	1380.0	1420.0	1040.0	1330.0	887.0	862.0	709.0	753.0	564.0	720.0	540.0	640.0	480.0	641.0	459.0	580.0	430.0	480.0	360.0
500	0.012	1500.0	1150.0	1183.3	866.7	1108.3	739.2	718.3	590.8	627.5	470.0	600.0	450.0	533.3	400.0	534.2	382.5	483.3	358.3	400.0	300.0
400	0.015	1200.0	920.0	946.7	693.3	886.7	591.3	574.7	472.7	502.0	376.0	480.0	360.0	426.7	320.0	427.3	306.0	386.7	286.7	320.0	240.0
300	0.020	900.0	690.0	710.0	520.0	665.0	443.5	431.0	354.5	376.5	282.0	360.0	270.0	320.0	240.0	320.5	229.5	290.0	215.0	240.0	180.0
200	0.030	600.0	460.0	473.3	346.7	443.3	295.7	287.3	236.3	251.0	188.0	240.0	180.0	213.3	160.0	213.7	153.0	193.3	143.3	160.0	120.0
100	0.060	300.0	230.0	236.7	173.3	221.7	147.8	143.7	118.2	125.5	94.0	120.0	90.0	106.7	80.0	106.8	76.5	96.7	71.7	80.0	60.0
50	0.120	150.0	115.0	118.8	86.7	110.8	73.9	71.8	59.1	62.8	47.0	60.0	45.0	53.3	40.0	53.4	38.3	48.3	35.8	40.0	30.0

FOV Comparison Table-16mm																					
WD	Magnification	16mm Industrial Lens FOV on Various Sensor Size																			
		4/3"		1.1"		1"		2/3"		1/1.7"		1/1.8"		1/2"		1/2.3"		1/2.5"		1/3"	
		H	V	H	V	H	V	H	V	H	V	H	V	H	V	H	V	H	V	H	V
1500	0.011	1687.5	1293.8	1331.3	975.0	1246.9	831.6	808.1	664.7	705.9	528.8	675.0	506.3	600.0	450.0	600.9	430.3	543.8	403.1	450.0	337.5
1200	0.013	1350.0	1035.0	1065.0	780.0	997.5	665.3	646.5	531.8	564.8	423.0	540.0	405.0	480.0	360.0	480.8	344.3	435.0	322.5	360.0	270.0
1000	0.016	1125.0	862.5	887.5	650.0	831.3	554.4	538.8	443.1	470.6	352.5	450.0	337.5	400.0	300.0	400.6	286.9	362.5	268.8	300.0	225.0
900	0.018	1012.5	776.3	798.8	585.0	748.1	498.9	484.9	398.8	423.6	317.3	405.0	303.8	360.0	270.0	360.6	258.2	326.3	241.9	270.0	202.5
800	0.020	900.0	690.0	710.0	520.0	665.0	443.5	431.0	354.5	376.5	282.0	360.0	270.0	320.0	240.0	320.5	229.5	290.0	215.0	240.0	180.0
700	0.023	787.5	603.8	621.3	455.0	581.9	388.1	377.1	310.2	329.4	246.8	315.0	236.3	280.0	210.0	280.4	200.8	253.8	188.1	210.0	157.5
600	0.027	675.0	517.5	532.5	390.0	498.8	332.6	323.3	265.9	282.4	211.5	270.0	202.5	240.0	180.0	240.4	172.1	217.5	161.3	180.0	135.0
500	0.032	562.5	431.3	443.8	325.0	415.6	277.2	269.4	221.6	235.3	176.3	225.0	168.0	200.0	150.0	200.3	143.4	181.3	134.4	150.0	112.5
400	0.040	450.0	345.0	355.0	260.0	332.5	221.8	215.5	177.3	188.3	141.0	180.0	135.0	160.0	120.0</						

LENS FIELD OF VIEW

LENS FIELD OF VIEW

FOV Comparison Table-25mm																					
25mm Industrial Lens FOV on Various Sensor Size																					
WD	Magnification	4/3"		1.1"		1"		2/3"		1/1.7"		1/1.8"		1/2"		1/2.3"		1/2.5"		1/3"	
		H	V	H	V	H	V	H	V	H	V	H	V	H	V	H	V	H	V	H	V
1500	0.017	1080.0	828.0	852.0	624.0	798.0	532.2	517.2	425.4	451.8	338.4	432.0	324.0	384.0	288.0	384.6	275.4	348.0	258.0	288.0	216.0
1200	0.021	864.0	662.4	681.6	499.2	638.4	425.8	413.8	340.3	361.4	270.7	345.6	259.2	307.2	230.4	307.7	220.3	278.4	206.4	230.4	172.8
1000	0.025	720.0	552.0	568.0	416.0	532.0	354.8	344.8	283.6	301.2	225.6	288.0	216.0	256.0	192.0	256.4	183.6	232.0	172.0	192.0	144.0
900	0.028	648.0	496.8	511.2	374.4	478.8	319.3	310.3	255.2	271.1	203.0	259.2	194.4	230.4	172.8	230.8	165.2	208.8	154.8	172.8	129.6
800	0.031	576.0	441.6	454.4	332.8	425.6	283.8	275.8	226.9	241.0	180.5	230.4	172.8	204.8	153.6	205.1	146.9	185.6	137.6	153.6	115.2
700	0.036	504.0	386.4	397.6	291.2	372.4	248.4	241.4	198.5	210.8	157.9	201.6	151.2	179.2	134.4	179.5	128.5	162.4	120.4	134.4	100.8
600	0.042	432.0	331.2	340.8	249.6	319.2	212.9	206.9	170.2	180.7	135.4	172.8	129.6	153.6	115.2	153.8	110.2	139.2	103.2	115.2	86.4
500	0.050	360.0	276.0	284.0	208.0	266.0	177.4	172.4	141.8	150.6	112.8	144.0	108.0	128.0	96.0	128.2	91.8	116.0	86.0	96.0	72.0
400	0.063	288.0	220.8	227.2	166.4	212.8	141.9	137.9	113.4	120.5	90.2	115.2	86.4	102.4	76.8	102.6	73.4	92.8	68.8	76.8	57.6
300	0.083	216.0	165.6	170.4	124.8	159.6	106.4	103.4	85.1	90.4	67.7	86.4	64.8	76.8	57.6	76.9	55.1	69.6	51.6	57.6	43.2
200	0.125	144.0	110.4	113.6	83.2	106.4	71.0	69.0	56.7	60.2	45.1	57.6	43.2	51.2	38.4	51.3	36.7	46.4	34.4	38.4	28.8
100	0.250	72.0	55.2	56.8	41.6	53.2	35.5	34.5	28.4	30.1	22.6	28.8	21.6	25.6	19.2	25.6	18.4	23.2	17.2	19.2	14.4
50	0.500	36.0	27.6	28.4	20.8	26.6	17.7	17.2	14.2	15.1	11.3	14.4	10.8	12.8	9.6	12.8	9.2	11.6	8.6	9.6	7.2

FOV Comparison Table-75mm																					
75mm Industrial Lens FOV on Various Sensor Size																					
WD	Magnification	4/3"		1.1"		1"		2/3"		1/1.7"		1/1.8"		1/2"		1/2.3"		1/2.5"		1/3"	
		H	V	H	V	H	V	H	V	H	V	H	V	H	V	H	V	H	V	H	V
1500	0.050	360.0	276.0	284.0	208.0	266.0	177.4	172.4	141.8	150.6	112.8	144.0	108.0	128.0	96.0	128.2	91.8	116.0	86.0	96.0	72.0
1200	0.063	288.0	220.8	227.2	166.4	212.8	141.9	137.9	113.4	120.5	90.2	115.2	86.4	102.4	76.8	102.6	73.4	92.8	68.8	76.8	57.6
1000	0.075	240.0	184.0	189.3	138.7	177.3	118.3	114.9	94.5	100.4	75.2	96.0	72.0	85.3	64.0	85.5	61.2	77.3	57.3	64.0	48.0
900	0.083	216.0	165.6	170.4	124.8	159.6	106.4	103.4	85.1	90.4	67.7	86.4	64.8	76.8	57.6	76.9	55.1	69.6	51.6	57.6	43.2
800	0.094	192.0	147.2	151.5	110.9	141.9	94.6	91.9	75.6	80.3	60.2	76.8	57.6	68.3	51.2	68.4	49.0	61.9	45.9	51.2	38.4
700	0.107	168.0	128.8	132.5	97.1	124.1	82.8	80.5	66.2	70.3	52.6	67.2	50.4	59.7	44.8	59.8	42.8	54.1	40.1	44.8	33.6
600	0.125	144.0	110.4	113.6	83.2	106.4	71.0	69.0	56.7	60.2	45.1	57.6	43.2	51.2	38.4	51.3	36.7	46.4	34.4	38.4	28.8
500	0.150	120.0	92.0	94.7	69.3	88.7	59.1	57.5	47.3	50.2	37.6	48.0	36.0	42.7	32.0	42.7	30.6	38.7	28.7	32.0	24.0
400	0.188	96.0	73.6	75.7	55.5	70.9	47.3	46.0	37.8	40.2	30.1	38.4	28.8	34.1	25.6	34.2	24.5	30.9	22.9	25.6	19.2
300	0.250	72.0	55.2	56.8	41.6	53.2	35.5	34.5	28.4	30.1	22.6	28.8	21.6	25.6	19.2	25.6	18.4	23.2	17.2	19.2	14.4
200	0.375	48.0	36.8	37.9	27.7	35.5	23.7	23.0	18.9	20.1	15.0	19.2	14.4	17.1	12.8	17.1	12.2	15.5	11.5	12.8	9.6
100	0.750	24.0	18.4	18.9	13.9	17.7	11.8	11.5	9.5	10.0	7.5	9.6	7.2	8.5	6.4	8.5	6.1	7.7	5.7	6.4	4.8
50	1.500	12.0	9.2	9.5	6.9	8.9	5.9	5.7	4.7	5.0	3.8	4.8	3.6	4.3	3.2	4.3	3.1	3.9	2.9	3.2	2.4

FOV Comparison Table-35mm																					
35mm Industrial Lens FOV on Various Sensor Size																					
WD	Magnification	4/3"		1.1"		1"		2/3"		1/1.7"		1/1.8"		1/2"		1/2.3"		1/2.5"		1/3"	
		H	V	H	V	H	V	H	V	H	V	H	V	H	V	H	V	H	V	H	V
1500	0.023	771.4	591.4	608.6	445.7	570.0	380.1	369.4	303.9	322.7	241.7	308.6	231.4	274.3	205.7	274.7	196.7	248.6	184.3	205.7	154.3
1200	0.029	617.1	473.1	486.9	356.6	456.0	304.1	295.5	243.1	258.2	193.4	246.9	185.1	219.4	164.6	219.8	157.4	198.9	147.4	164.6	123.4
1000	0.035	514.3	394.3	405.7	297.1	380.0	253.4	246.3	202.6	215.1	161.1	205.7	154.3	182.9	137.1	183.1	131.1	165.7	122.9	137.1	102.9
900	0.039	462.9	354.9	365.1	267.4	342.0	228.1	221.7	182.3	193.6	145.0	185.1	138.9	164.6	123.4	164.8	118.0	149.1	110.6	123.4	92.6
800	0.044	411.4	315.4	324.6	237.7	304.0	202.7	197.0	162.1	172.1	128.9	164.6	123.4	146.3	109.7	146.5	104.9	132.6	98.3	109.7	82.3
700	0.050	360.0	276.0	284.0	208.0	266.0	177.4	172.4	141.8	150.6	112.8	144.0	108.0	128.0	96.0	128.2	91.8	116.0	86.0	96.0	72.0
600	0.058	308.6	236.6	243.4	178.3	228.0	152.1	147.8	121.5	129.1	96.7	123.4	92.6	109.7	82.3	109.9	78.7	99.4	73.7	82.3	61.7
500	0.070	257.1	197.1	202.9	148.6	190.0	126.7	123.1	101.3	107.6	80.6	102.9	77.1	91.4	68.6	91.6	65.6	82.9	61.4	68.6	51.4
400	0.088	205.7	157.7	162.3	118.9	152.0	101.4	98.5	81.0	86.1	64.5	82.3	61.7	73.1	54.9	73.3	52.5	66.3	49.1	54.9	41.1
300	0.117	154.3	118.3	121.7	89.1	114.0	76.0	73.9	60.8	64.5	48.3	61.7	46.3	54.9	41.1	54.9	39.3	49.7	36.9	41.1	30.9
200	0.175	102.9	78.9	81.1	59.4	76.0	50.7	49.3	40.5	43.0	32.2	41.1	30.9	36.6	27.4	36.6	26.2	33.1	24.6	27.4	20.6
100	0.350	51.4	39.4	40.6	29.7	38.0	25.3	24.6	20.3	21.5	16.1	20.6	15.4	18.3	13.7	18.3	13.1	16.6	12.3	13.7	10.3
50	0.700	25.7	19.7	20.3	14.9	19.0	12.7	12.3	10.1	10.8	8.1	10.3	7.7	9.1	6.9	9.2	6.6	8.3	6.1	6.9	5.1

FOV Comparison Table-50mm																					
50mm Industrial Lens FOV on Various Sensor Size																					
WD	Magnification	4/3"		1.1"		1"		2/3"		1/1.7"		1/1.8"		1/2"		1/2.3"		1/2.5"		1/3"	
		H	V	H	V	H	V	H	V	H	V	H	V	H	V	H	V	H	V	H	V
1500	0.033	540.0	414.0	426.0	312.0	399.0	266.1	258.6	212.7	225.9	169.2	216.0	162.0	192.0	144.0	192.3	137.7	174.0	129.0	144.0	108.0
1200	0.042	432.0	331.2	340.8	249.6	319.2	212.9	206.9	170.2	180.7	135.4	172.8	129.6	153.6	115.2	153.8	110.2	139.2	103.2	115.2	86.4
1000	0.050	360.0	276.0	284.0	208.0	266.0	177.4	172.4	141.8	150.6	112.8	144.0	108.0	128.0	96.0	128.2	91.8	116.0	86.0	96.0	72.0
900	0.056	324.0	248.4	255.6	187.2	239.4	159.7	155.2	127.6	135.5	101.5	129.6	97.2	115.2	86.4	115.4	82.6	104.4	77.4	86.4	64.8
800	0.063	288.0	220.8	227.2	166.4	212.8	141.9	137.9	113.4	120.5	90.2	115.2	86.4	102.4	76.8	102.6	73.4	92.8	68.8	76.8	57.6
700	0.071	252.0	193.2	198.8	145.6	186.2	124.2	120.7	99.3	105.4	79.0	100.8	75.6	89.6	67.2	89.7	64.3	81.2	60.2	67.2	50.4
600	0.083	216.0	165.6	170.4	124.8	159.6	106.4	103.4	85.1	90.4	67.7	86.4	64.8	76.8	57.6	76.9	55.1	69.6	51.6	57.6	43.2
500	0.100	180.0	138.0	142.0	104.0	133.0	88.7	86.2	70.9	75.3	56.4	72.0	54.0	64.0	48.0	64.1	45.9	58.0	43.0	48.0	36.0
400	0.125	144.0	110.4	113.6	83.2	106.4	71.0	69.0	56.7	60.2	45.1	57.6	43.2	51.2	38.4	51.3	36.7	46.4	34.4	38.4	28.8
300	0.167	108.0	82.8	85.2	62.4	79.8	53.2	51.7	42.5	45.2	33.8	43.2	32.4	38.4	28.8	38.5	27.5	34.8	25.8	28.8	21.6
200	0.250	72.0	55.2	56.8	41.6	53.2	35.5	34.5	28.4	30.1	22.6	28.8	21.6	25.6	19.2	25.6	18.4	23.2	17.2	19.2	14.4
100	0.500	36.0	27.6	28.4	20.8	26.6	17.7	17.2	14.2	15.1	11.3	14.4	10.8	12.8	9.6	12.8	9.2	11.6	8.6	9.6	7.

VIA-MF series

A-series HD 20 Megapixel Prime Lens



DIMENSION (Unit: mm)

VIA-MF1228-20M

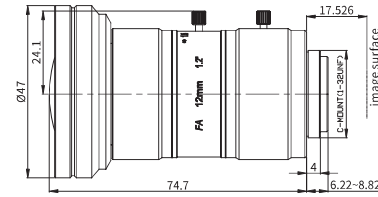

VIA-MF1628-20M

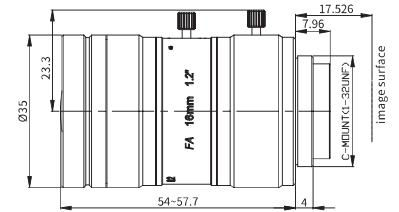

VIA-MF2528-20M

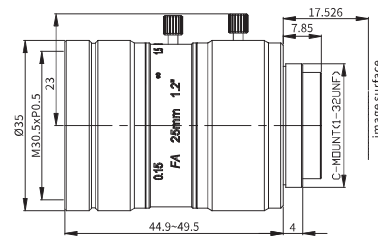

VIA-MF3528-20M

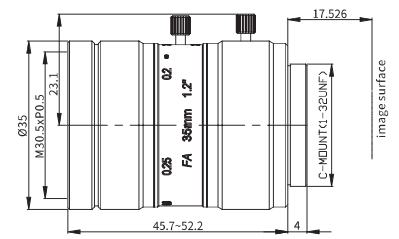

VIA-MF5028-20M

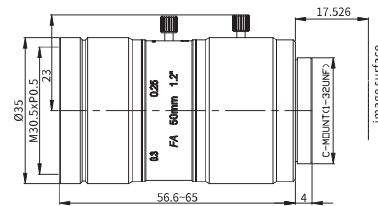

FEATURES

- Beautiful Appearance
Compact design, stable structure
- High Resolution
Support up to 1.2" cameras, compatible with mainstream 20MP industrial cameras
- Low Distortion
Distortion is less than 0.22%, and the lowest is 0.01%

MODEL DESCRIPTION

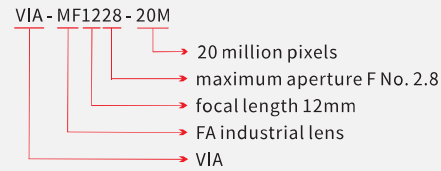

* please consult our salesperson to customize other models as need

PARAMETERS

Model	Focal Length	F No.	Maximum Sensor Size	FOV (Unit: mm)			TV Distortion	Minimum Distance	Filter Size	Mount
				1.2"	1.1"	1"				
VIA-MF1228-20M	12mm	F2.8-F16	1.2"	62.5x55.5	61.2x46.8	58x40.6	<-0.22%	100mm	—	C-Mount
VIA-MF1628-20M	16mm	F2.8-F16	1.2"	49x43	47.8x36	45.1x31	<-0.09%	150mm	—	C-Mount
VIA-MF2528-20M	25mm	F2.8-F16	1.2"	32.5x28.3	31.7x23.5	29.8x20.1	<-0.07%	150mm	M30.5*P0.5	C-Mount
VIA-MF3528-20M	35mm	F2.8-F16	1.2"	23.5x20.4	22.9x16.9	21.5x14.4	<-0.08%	150mm	M30.5*P0.5	C-Mount
VIA-MF5028-20M	50mm	F2.8-F16	1.2"	16.6x14.4	16.1x11.8	15.1x10.1	<-0.02%	250mm	M30.5*P0.5	C-Mount

VIA-MF series

A-series HD 10 Megapixel Prime Lens



DIMENSION (Unit: mm)

VIA-MF0828-10M

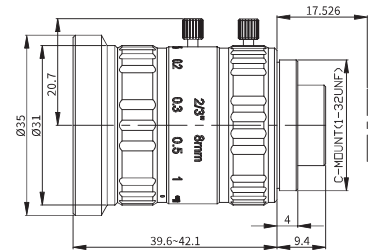

VIA-MF1228-10M

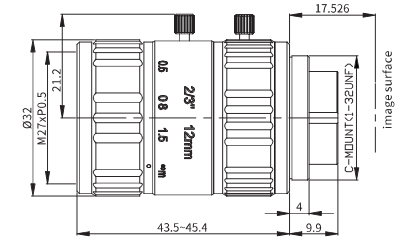

VIA-MF1628-10M

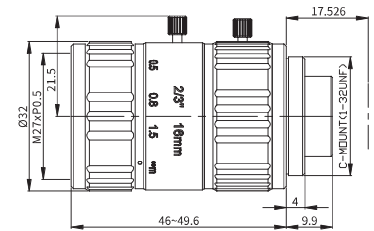

VIA-MF2528-10M

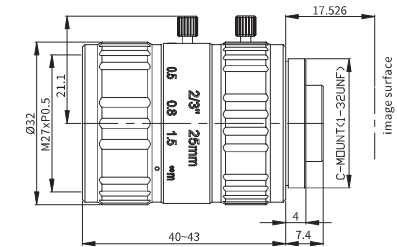

VIA-MF3528-10M

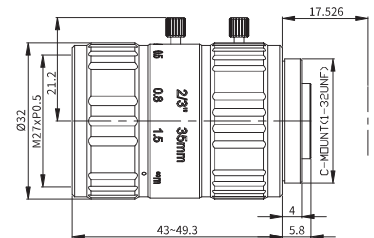

VIA-MF5028-10M

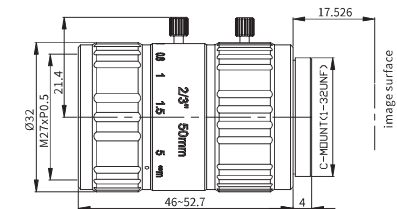

FEATURES

- Beautiful Appearance
Delicate and compact
- High Resolution
Support up to 2/3" cameras, compatible with mainstream 10MP industrial cameras, applicable to pixel size above 3.45um
- Low Distortion
Distortion is less than 0.29%, and the lowest is 0.01%
- Multiple Focal Lengths
Cover 8-50mm, wide application

MODEL DESCRIPTION

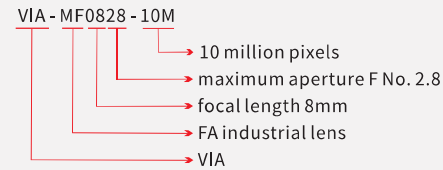

* please consult our salesperson to customize other models as need

PARAMETERS

Model	Focal Length	F No.	Maximum Sensor Size	FOV (Unit: mm)			TV Distortion	Minimum Distance	Filter Size	Mount
				2/3"	1/1.7"	1/1.8"				
VIA-MF0828-10M	8mm	F2.8-F16	2/3"	57.8x45	50.4x38.8	48.4x37.3	<-0.29%	100mm	—	C-Mount
VIA-MF1228-10M	12mm	F2.8-F16	2/3"	40.4x30.8	34.8x26.4	33.4x25.3	<-0.13%	150mm	M27*P0.5	C-Mount
VIA-MF1628-10M	16mm	F2.8-F16	2/3"	30.8x23.4	26.4x19.9	25.3x19.1	<-0.07%	150mm	M27*P0.5	C-Mount
VIA-MF2528-10M	25mm	F2.8-F16	2/3"	20x15.1	17.1x12.8	16.3x12.3	<-0.04%	150mm	M27*P0.5	C-Mount
VIA-MF3528-10M	35mm	F2.8-F16	2/3"	14.4x10.8	12.2x9.2	11.7x8.8	<-0.06%	200mm	M27*P0.5	C-Mount
VIA-MF5028-10M	50mm	F2.8-F16	2/3"	10.1x7.5	8.6x6.4	8.2x6.1	<-0.01%	300mm	M27*P0.5	C-Mount

VIA-TLH series

J111-series Telecentric Lens



PARAMETERS

Model	Lighting Type	Magnificationβ (%)	WD (mm)	Depth of Field (mm)	F No.	Sensor Size	Optical Distortion (%)	Telecentricity (°)	MTF>0.3 (LP/mm)	Mount	Object FOV maximum (mm)	Object FOV (mm)		
												1" (12.8x9.6)	1.1" (14.2X10.4)	
VIA-TLH04-178	non-coaxial	0.4	178	3.5	F6	1.1" φ18.5mm	<0.022	<0.05	180	C	46.25	32x24	35.5x26	
VIA-TLH0345-178	non-coaxial	0.345	178	4.2	F6	1.1" φ18.5mm	<0.022	<0.05	180	C	53.6	37x27.8	41.1x30.1	
VIA-TLH03-200	coaxial	0.3	200	5.2	F6	1.1" φ18.5mm	<0.022	<0.03	160	C	61.6	42.6x32	47.3x34.6	
VIA-TLH0275-200	non-coaxial	0.275	200	6	F6	1.1" φ18.5mm	<0.052	<0.02	160	C	67.2	46.5x34.9	51.6x37.8	
VIA-TLH025-230	coaxial	0.25	230	6.5	F6	1.1" φ18.5mm	<0.022	<0.02	160	C	74	51.2x38.4	56.8x41.6	
VIA-TLH022-200	non-coaxial	0.22	200	8	F5.3	1.1" φ18.5mm	<0.052	<0.16	180	C	84	58.1x43.6	64.5x47.2	
VIA-TLH0172-230	coaxial	0.172	230	12	F5.6	1.1" φ18.5mm	<0.052	<0.05	160	C	107.5	74.4x55.8	82.5x60.4	
VIA-TLH0153-250	non-coaxial	0.153	250	15	F5.6	1.1" φ18.5mm	<0.052	<0.05	160	C	120.9	83.6x62.7	92.8x67.9	

DIMENSION (Unit: mm)

VIA-TLH15-110

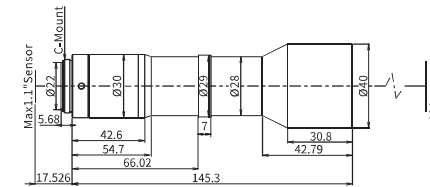

VIA-TLH10-110

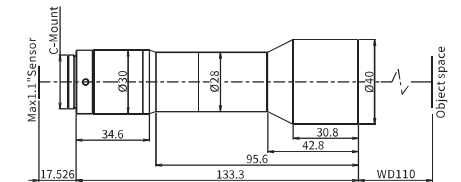

VIA-TLH10-220

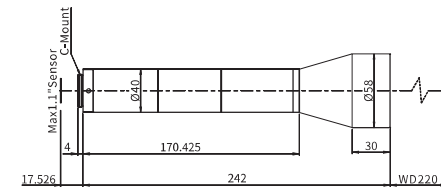

VIA-TLH10-178

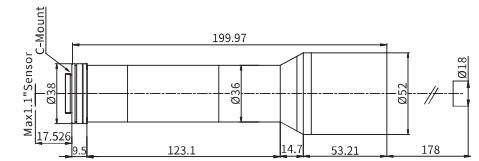

VIA-TLH08-110

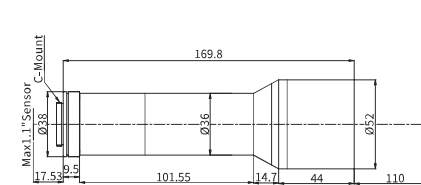

VIA-TLH08-220

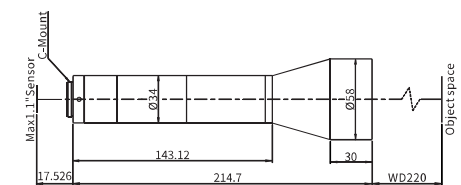

FEATURES

- Support up to 1.1"φ18.5mm sensor size camera
- Ultra-large depth of field design, meet products' high and low difference imaging needs
- High-precision calibration, hardware measurement error in the entire field of view <0.3Pixel
- Excellent bilateral telecentric optical path, ultra-low distortion design
- Lightweight and tight structure design, stable and extreme performance under high-speed movement

MODEL DESCRIPTION

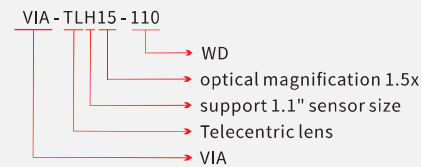

■ please consult our salesperson to customize other models as need

PARAMETERS

Model	Lighting Type	Magnificationβ (%)	WD (mm)	Depth of Field (mm)	F No.	Sensor Size	Optical Distortion (%)	Telecentricity (°)	MTF>0.3 (LP/mm)	Mount	Object FOV maximum (mm)	Object FOV (mm)		
												1" (12.8x9.6)	1.1" (14.2X10.4)	
VIA-TLH15-110	non-coaxial	1.5	110	1	F11	1.1" φ18.5mm	<0.047	<0.05	120	C	12.3	8.5x6.4	9.4x6.9	
VIA-TLH10-110	non-coaxial	1	110	1.25	F7	1.1" φ18.5mm	<0.047	<0.05	120	C	18.5	12.8x9.6	14.2x10.4	
VIA-TLH10-110C	coaxial	1	110	1.25	F7	1.1" φ18.5mm	<0.047	<0.05	120	C	18.5	12.8x9.6	14.2x10.4	
VIA-TLH10-220	non-coaxial	1	220	0.68	F8.3	1.1" φ18.5mm	<0.047	<0.05	145	C	18.5	12.8x9.6	14.2x10.4	
VIA-TLH10-178	non-coaxial	1	178	1.5	F11	1.1" φ18.5mm	<0.032	<0.03	110	C	18.5	12.8x9.6	14.2x10.4	
VIA-TLH08-110	non-coaxial	0.8	110	2.5	F6	1.1" φ18.5mm	<0.050	<0.05	145	C	23.1	16x12	17.7x13	
VIA-TLH08-220	non-coaxial	0.8	220	1.03	F8	1.1" φ18.5mm	<0.050	<0.05	125	C	23.1	16x12	17.7x13	
VIA-TLH07-110	non-coaxial	0.7	110	2.5	F6	1.1" φ18.5mm	<0.050	<0.05	145	C	26.4	18.2x13.7	20.2x14.8	
VIA-TLH06-220	non-coaxial	0.6	190	1.85	F8	1.1" φ18.5mm	<0.050	<0.05	125	C	30.8	21.3x16	23.6x17.3	
VIA-TLH052-110	non-coaxial	0.52	110	3.5	F6	1.1" φ18.5mm	<0.032	<0.05	160	C	35.5	24.6x18.4	27.3x20	
VIA-TLH05-220	non-coaxial	0.5	220	2.7	F8	1.1" φ18.5mm	<0.052	<0.05	120	C	37	25.6x19.2	28.4x20.8	

DIMENSION (Unit: mm)

VIA-TLH07-110

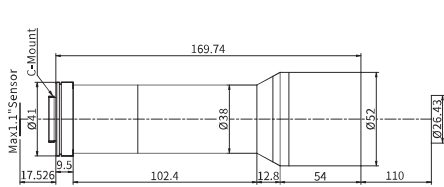

VIA-TLH06-220

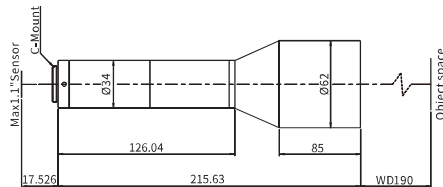

DIMENSION (Unit: mm)

VIA-TLH025-230

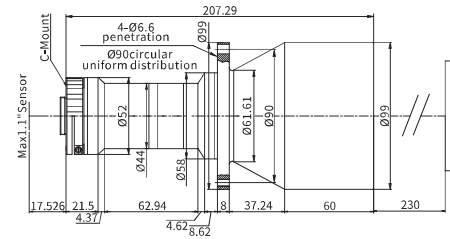

VIA-TLH022-200

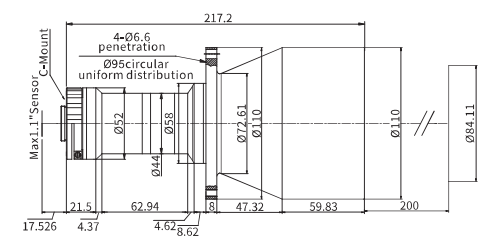

VIA-TLH052-110

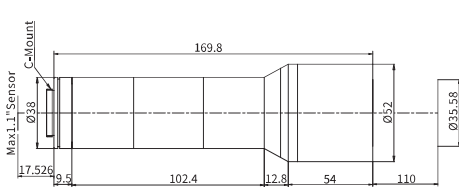

VIA-TLH05-220

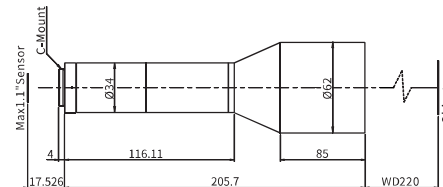

VIA-TLH0172-230

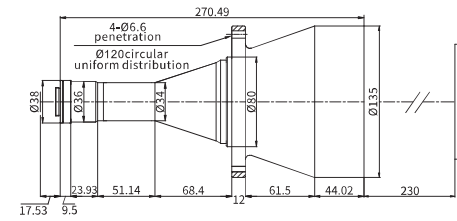

VIA-TLH0153-250

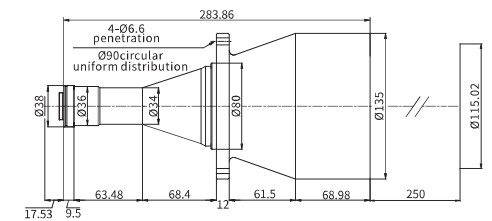

VIA-TLH04-178

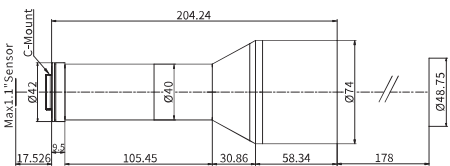

VIA-TLH0345-178

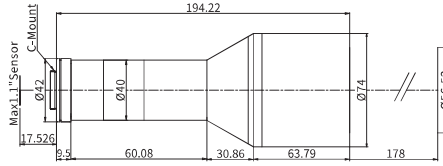

VIA-TLH03-200

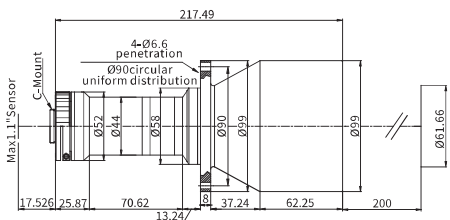

VIA-TLH0275-200

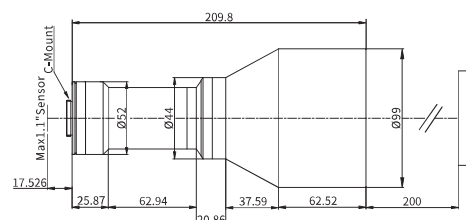

VIA-TLM series

J230-series Telecentric Lens



PARAMETERS

Model	Lighting Type	Object FOV maximum (mm)	Magnification (X)	WD (mm)	Depth of Field (mm)	F.No.	MTF>0.3 (LP/mm)	Optical Distortion (%)	Telecentricity (%)	Mount	Sensor Size	Object FOV (mm)		
												1/2.5" (5.7x4.2)	1/2.3" (6.4x4.5)	2/3" (8.4x7.1)
VIA-TLM05-275	non-coaxial	22	0.5	275	4.5	F9	110	<0.032	<0.03	C	2/3" φ11mm	11.4x8.4	12.8x9	16.8x14.2
VIA-TLM05-108	non-coaxial	36.6	0.3	108	7	F7	130	<0.032	<0.03	C	2/3" φ11mm	19x14	21.3x15	28x23.6
VIA-TLM03-178	non-coaxial	36.6	0.3	178	6.5	F6	160	<0.032	<0.01	C	2/3" φ11mm	19x14	21.3x15	28x23.6
VIA-TLM0265-178	non-coaxial	41.5	0.265	178	9	F6	160	<0.032	<0.01	C	2/3" φ11mm	21.5x15.8	24.1x16.9	31.6x26.7
VIA-TLM022-200	non-coaxial	50	0.22	200	8.5	F6	160	<0.022	<0.01	C	2/3" φ11mm	25.9x19	29x20.4	38.1x32.2
VIA-TLM02-178	non-coaxial	55	0.2	178	9	F7	135	<0.032	<0.03	C	2/3" φ11mm	28.5x21	32x22.5	42x35.5
VIA-TLM0178-158	non-coaxial	61.7	0.178	158	17.5	F5.3	185	<0.012	<0.05	C	2/3" φ11mm	32x23.5	35.9x25.2	47.1x39.8
VIA-TLM014-200	non-coaxial	78.5	0.14	200	22	F6.5	145	<0.022	<0.02	C	2/3" φ11mm	40.7x30	45.7x32.1	60x50.7
VIA-TLM0095-250	non-coaxial	115.7	0.95	250	48	F7.5	125	<0.052	<0.05	C	2/3" φ11mm	60x44.2	67.3x47.3	88.4x74.7

DIMENSION (Unit: mm)

VIA-TLM20-110

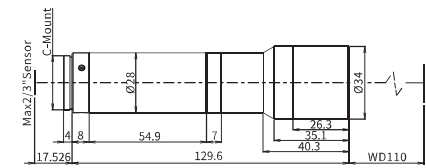

VIA-TLM20-110C

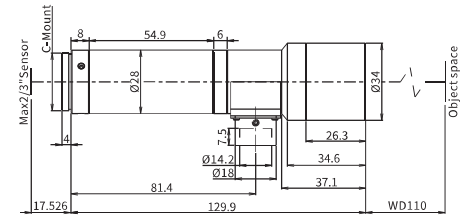

FEATURES

- Support up to 2/3"φ11mm sensor size camera
- Ultra-large depth of field design, meet products' high and low difference imaging needs
- High-precision calibration, hardware measurement error in the entire field of view <0.3Pixel
- Excellent bilateral telecentric optical path, ultra-low distortion design
- Lightweight and tight structure design, stable and extreme performance under high-speed movement

MODEL DESCRIPTION

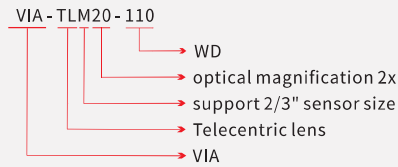

* please consult our salesperson to customize other models as need

PARAMETERS

Model	Lighting Type	Object FOV maximum (mm)	Magnification (X)	WD (mm)	Depth of Field (mm)	F.No.	MTF>0.3 (LP/mm)	Optical Distortion (%)	Telecentricity (%)	Mount	Sensor Size	Object FOV (mm)		
												1/2.5" (5.7x4.2)	1/2.3" (6.4x4.5)	2/3" (8.4x7.1)
VIA-TLM20-110	non-coaxial	5.5	2	110	0.55	F9	125	<0.048	<0.05	C	2/3" φ11mm	2.85x2.1	3.2x2.2	4.2x3.5
VIA-TLM20-110C	coaxial	5.5	2	110	0.55	F9	125	<0.048	<0.05	C	2/3" φ11mm	2.85x2.1	3.2x2.2	4.2x3.5
VIA-TLM15-110	non-coaxial	7.3	1.5	110	0.85	F9	120	<0.048	<0.05	C	2/3" φ11mm	3.8x2.8	4.2x3	5.6x4.7
VIA-TLM15-110C	coaxial	7.3	1.5	110	0.85	F9	120	<0.048	<0.05	C	2/3" φ11mm	3.8x2.8	4.2x3	5.6x4.7
VIA-TLM10-110	non-coaxial	11	1	110	1.5	F7	125	<0.048	<0.05	C	2/3" φ11mm	5.7x4.2	6.4x4.5	8.4x7.1
VIA-TLM10-110C	coaxial	11	1	110	1.5	F7	125	<0.048	<0.05	C	2/3" φ11mm	5.7x4.2	6.4x4.5	8.4x7.1
VIA-TLM08-110	non-coaxial	13.7	0.8	110	1.8	F9	130	<0.048	<0.05	C	2/3" φ11mm	7.1x5.2	8x5.6	10.5x8.8
VIA-TLM08-110C	coaxial	13.7	0.8	110	1.8	F9	130	<0.048	<0.05	C	2/3" φ11mm	7.1x5.2	8x5.6	10.5x8.8
VIA-TLM05-110	non-coaxial	22	0.5	110	3.5	F8	120	<0.032	<0.03	C	2/3" φ11mm	11.4x8.4	12.8x9	16.8x14.2
VIA-TLM05-110C	coaxial	22	0.5	110	3.5	F8	120	<0.032	<0.03	C	2/3" φ11mm	11.4x8.4	12.8x9	16.8x14.2
VIA-TLM05-178	non-coaxial	22	0.5	178	4	F9	110	<0.032	<0.03	C	2/3" φ11mm	11.4x8.4	12.8x9	16.8x14.2

VIA-TLM15-110

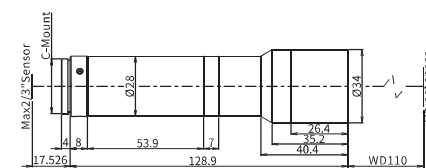

VIA-TLM15-110C

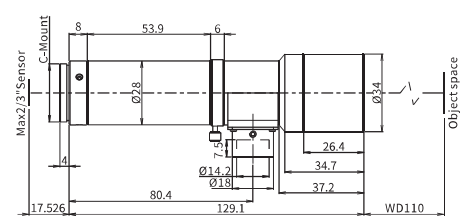

VIA-TLM10-110

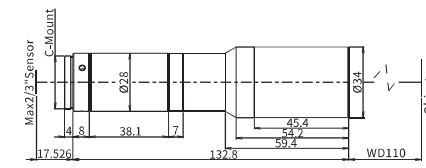

VIA-TLM10-110C

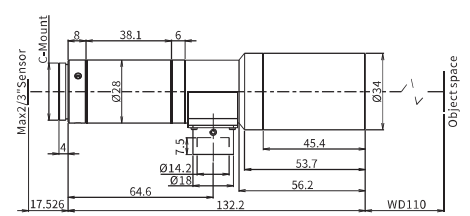

DIMENSION (Unit: mm)

VIA-TLM08-110

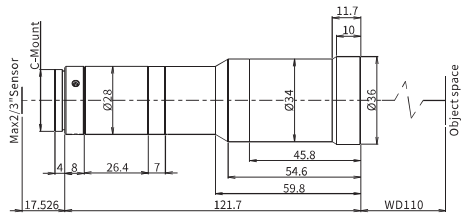

VIA-TLM08-110C

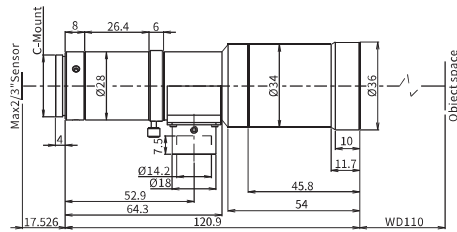

DIMENSION (Unit: mm)

VIA-TLM0265-178

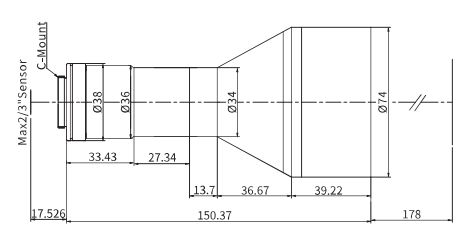

VIA-TLM022-200

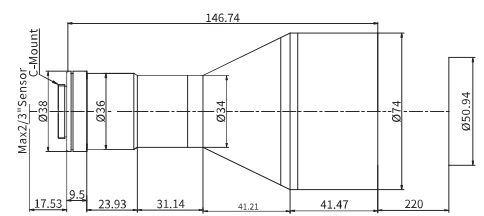

VIA-TLM05-110

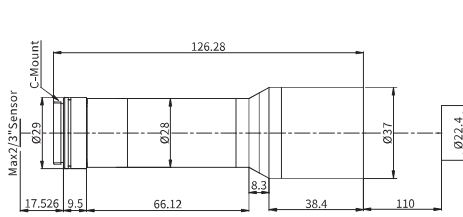

VIA-TLM05-110C

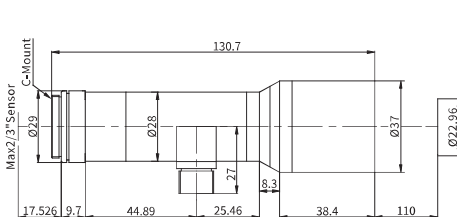

VIA-TLM02-178

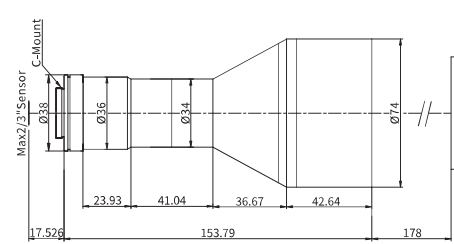

VIA-TLM0178-158

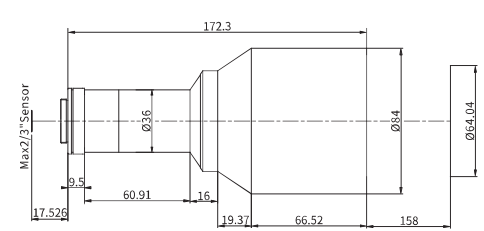

VIA-TLM05-178

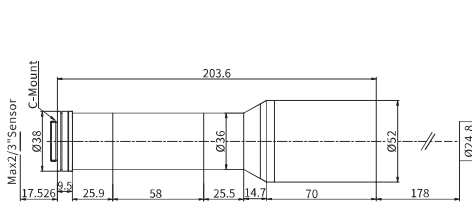

VIA-TLM05-275

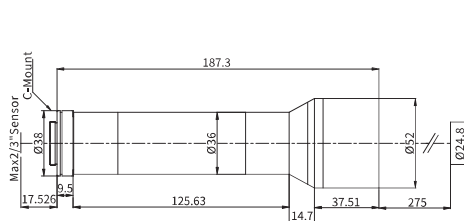

VIA-TLM014-200

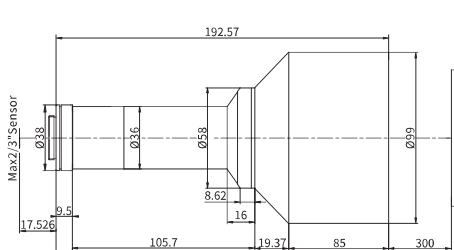

VIA-TLM0095-250

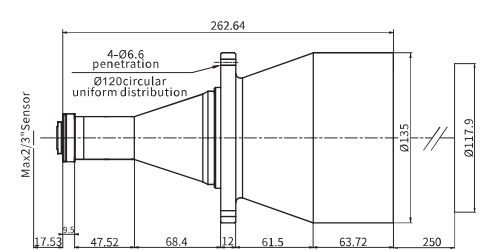

VIA-TLM05-108

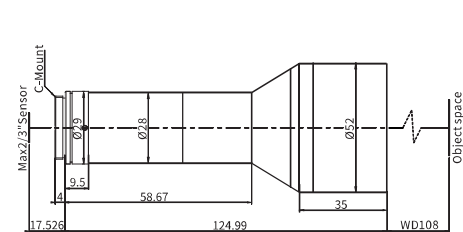

VIA-TLM03-178

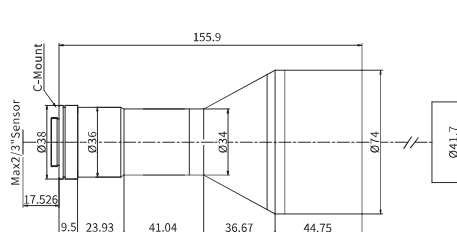



SpecAlvision Ltd.

Metelinrinne 16, FIN-90420 OULU

+358 50 413 8839

timo.jauhiainen@specaivision.com

www.specaivision.com